

BROEN LAB

Installation, User and Service instruction For burning gas fittings 99G0141

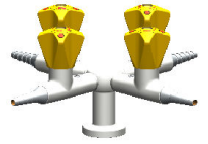

USER/OPERATING INSTRUCTIONS

Press/turn headwork and handle:

To open valves with press/turn handle, press down the yellow handle and turn it counter clock wise up to 90 degrees, See fig 1.

Needle flow headwork and handle:

To open valves with needle flow headwork, turn the handle counter clock wise up to 3x360 degrees, See fig 2.

Lift/turn valve and handle:

To open valves with lift/turn handle, pull up the yellow handle and turn it counter clock wise up to 90 degrees, See fig 3.

Quick coupling with detachable hose nozzle:

To detach the nozzle on valves with quick coupling first pull the sleeve on the coupling back, then pull the nozzle out, See fig 4.

Shut off Ballofix ball valve on BROEN Premium fittings:

To close the build in ball valve on premium fittings, use hex 3mm Allen key and turn it 90 degrees, See fig. 5.

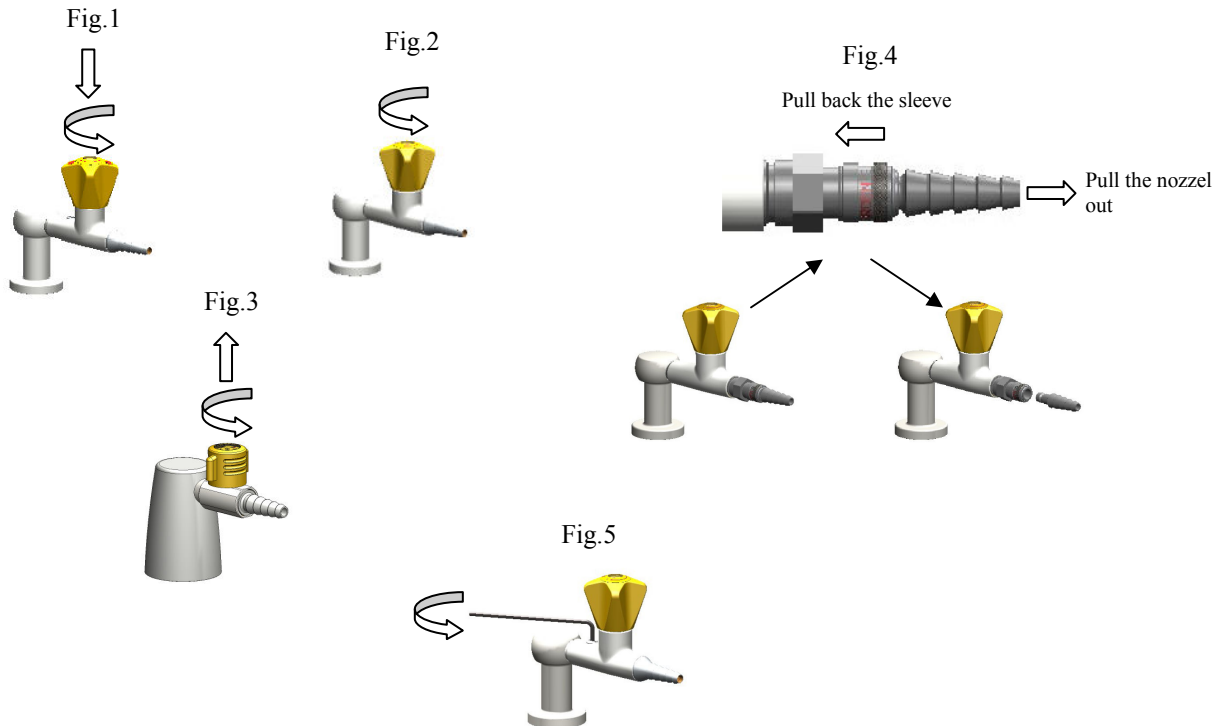

SERVICE AND MAINTENANCE

Fittings:

All parts in BROEN UniFlex burning gas fittings are fixed for security reasons and can therefore not be serviced. By failure on the fitting is replacement the only option.